

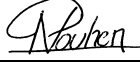



Name: P. NOUHEN Visa: 	Name: M.NARCHE Visa: 	 Fuji Electric Instrumentation & Control
EDITING	APPROVAL	

DESCRIPTION	CODE	Price £ Base
Recording Head for PHA/PHC/PHE9 Recorders	PHZH1002	£64
Recording Head for PHE 1 & 2 channel Recorders	PHZH2002	£64
180mm Fan Fold Chart Paper to suit Fuji PHA/PHB (box of 6 pcs)	PHAZ5-CHT	£60
100mm Fan Fold Chart Paper to suit Fuji PHC/PHE (box of 6 pcs)	PHCZ5-CHT	£30
Chart illumination unit	PHZL8201	£238
Chart illumination lamp	PHZL8001	£179
Shunt resistor (10 ohm)	PHZT8101	£42
Shunt resistor (250 ohm)	PDZS1001	£5
<b>Alarm output/External control unit (Note 1)</b> 6-point alarm/3-point external control 12-point alarm/3-point external control 6-point alarm for ch7-12	PHZK8601 PHZK8201 PHZK8701	£288 £506 £218
<b>RS-485 interface (Note 1)</b>	ZZPPHA2-A271	£397
<b>PC Software configuration for PHC/PHA (Note 1)</b> Without RS232/RS485 converter & cables With RS232/RS485 converter & cables	CONF-PHC/PHA CONF-PHC/PHA-CONV	£163 £650

**Note 1** : These options are not available with PHB 24 points recording (dot recording) recorder

Name: P. NOUHEN Visa: 	Name: M.NARCHE Visa: 	 Fuji Electric Instrumentation & Control
EDITING	APPROVAL	INDEX

PHA Recorder BLOCK A (Case Assembly)

Item N°	Parts name	Parts N° & DWG N°	Q'ty	Price £ Base
2	Door Ass'y	(Ver.1,2) ZZPPHA1-A020 (TK7C5207C1)	1pce	£149
		(Ver.3) ZZPPHA3-A020 (TK7C5207D1)	1pce	£149
		(Ver.4) ZZPPHA4-A020 (TK7L2304C1)	1pce	£149
3	Fuse Holder	(75859N11)	1pce	£6
4	Fuse	ZZPPHA1-A040 (757651)	10/pkg	£14
5	Main Board for 6 continuous	(Ver.1,2) ZZPPHA1-A053	1pce	£917
		(Ver.3) ZZPPHA3-A053 (TK7G9176C4)	1pce	£917
	Main Board for 6 dot	(Ver.4) ZZPPHA4-A053 (TK7L2303C4)	1pce	£917
		(Ver.1,2) ZZPPHA1-A054	1pce	£917
	Main Board for 12 continuous	(Ver.3) ZZPPHA3-A054 (TK7G9176C4)	1pce	£917
		(Ver.4) ZZPPHA4-A054 (TK7L2303C4)	1pce	£917
	Main Board for 12 dot	(Ver.1,2) ZZPPHA1-A056	1pce	£1,442
		(Ver.3) ZZPPHA3-A056 (TK7G9176C5)	1pce	£1,442
		(Ver.4) ZZPPHA4-A056 (TK7L2303C5)	1pce	£1,442
		(Ver.1,2) ZZPPHA1-A055	1pce	£1,442
8	Lithium Battery	(Ver.3) ZZPPHA3-A055 (TK7G9176C5)	1pce	£1,442
		(Ver.4) ZZPPHA4-A055 (TK7L2303C5)	1pce	£1,442
		(Ver.1,2) ZZPPHA1-A080 (TK7C9980P1)	1pce	£21
		(Ver.3,4) ZZPPHA3-A080 (TK7G8473P1)	1pce	£21
		ZZPPHA1-A100 (77271N299)	10/pkg	£6
10	Short Circuit Pin			
11	Power Supply Unit	ZZPPHA1-A110 (TK7C8792P1)	1pce	£303
13	Terminal Unit	ZZPPHA1-A130 (TK4B1415P1)	1pce	£23
14	Terminal Case	(TK343701P1)	1pce	£10
16	Mounting Bracket	ZZPPHA1-A160 (TK566023C2)	1pce	£17
17	Input Terminal Ass'y	ZZPPHA1-A170 (TK4B3163C1)	1pce	£97
19	Power Supply Terminal	ZZPPHA1-A190 (TK4B3842P1)	1pce	£12
20	Specification Name Plate	(TK4A4826P1)	1pce	£3
21	Switch	ZZPPHA1-A210 (77501N1)	1pce	£7
22	Guiding Plate	(Ver.1,2) ZZPPHA1-A220 (TK7D6943P1)	1pce	£12
		(Ver.3,4) ZZPPHA3-A220 (TK7E4659P1)	1pce	£12
28	Mounting Metal Fitting	ZZPPHA1-A280 (TK7D3856P1)	1pce	£25
29	Transmission Terminal Ass'y	ZZPPHA1-A290 (TK7D3010C1)	1pce	£56
30	Pan Head Screw With Washer	ZZPPHA1-A300 (813062R5x6mm)	60/pkg	£2
31	Pan Head Tapping Screw	ZZPPHA1-A310 (813623x6mm)	60/pkg	£1
32	Pin	ZZPPHA1-A320 (TK7C4245P1)	10/pkg	£17
33	Spring	ZZPPHA1-A330 (83602N14)	10/pkg	£15
34	Power Cable Ass'y	(TK4B3876C1)	1pce	£14

Name: P. NOUHEN  
Visa:



EDITING

Name: M.NARCHE  
Visa:

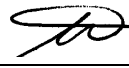

APPROVAL

**COULTON**  
Fuji Electric Instrumentation & Control

INDEX

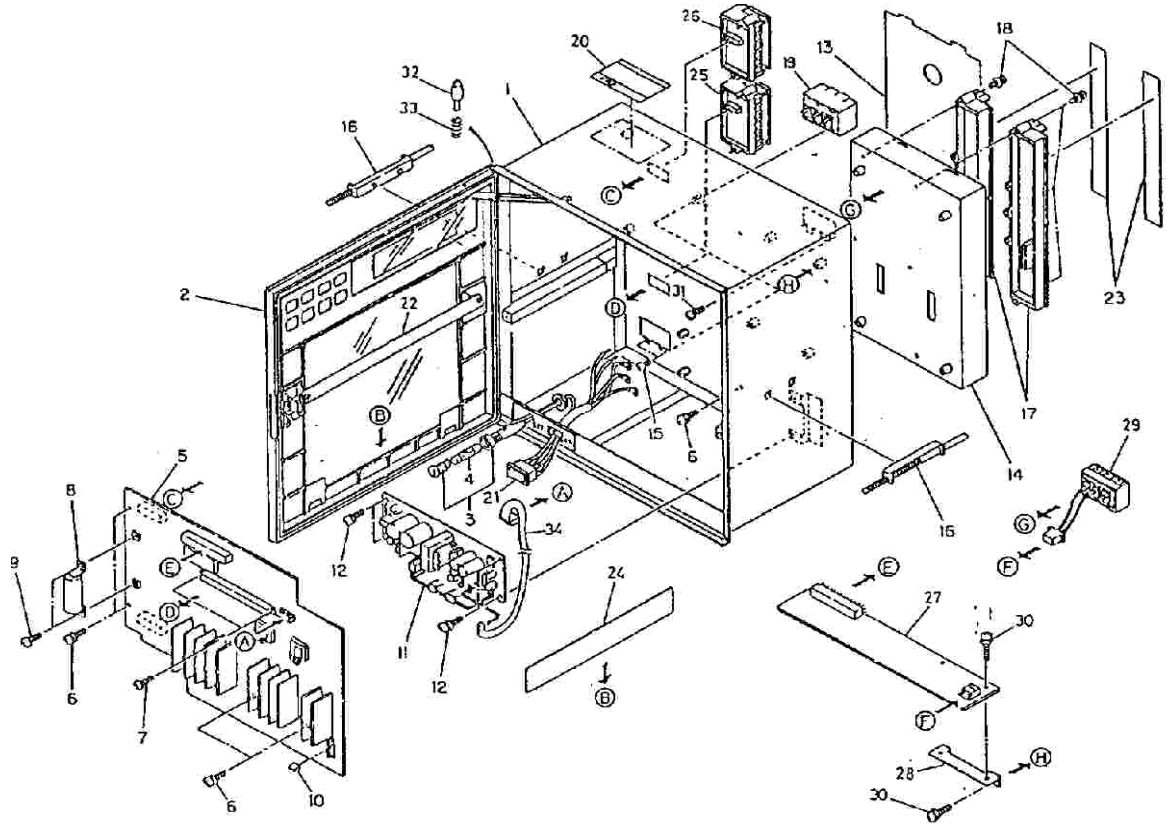

Name: P. NOUHEN Visa: 	Name: M.NARCHE Visa: 	 Fuji Electric Instrumentation & Control
<b>EDITING</b>	<b>APPROVAL</b>	<b>INDEX</b>

PHA Recorder BLOCK B (Main Assembly)

Item N°	Parts name	Parts N° & DWG N°	Q'ty	Price £ Base
1	Main Frame	(TK201830P1)	1pce	£64
2	Traversing Shaft	(TK7C8010P1)	1pce	£10
4	E Snap Ring	(835134)	10/pkg	£5
5	Carrier	(Ver.1,2) ZZPPHA1-B050 (TK7C6325C1)	1pce	£83
		(Ver.3,4) ZZPPHA3-B050 (TK7D6169C1)	1pce	£83
9	Carridge Motor	ZZPPHA1-B090 (TK7C6322P1)	1pce	£69
11	Dram	(Ver.1,2) (TK7C8107P1)	1pce	£17
		(Ver.3,4) (TK7D8083P1)	1pce	£17
13	Cable(Driving Wire)	ZZPPHA1-B130 (TK7C6323P1)	1pce	£18
15	Compression Coil Spring	(Ver.1,2) (TK7K8581P1)	1pce	£14
		(Ver.3,4) (83602N15)	1pce	£14
16	Tension Metal Fittings	(TK7C8003P1)	1pce	£3
17	Bearing	(TK7L2301P19)	1pce	£14
18	Glip Snap Ring	(83553N5)	100/pkg	£14
19	Glip Snap Ring	(83553N6)	100/pkg	£14
20	Paper Feed Reat Unit	(TK7C8112C1)	1pce	£257
24	Chart Motor	ZZPPHA1-B240 (TK7C8014P1)	1pce	£110
27	Pully	(TK7C8007P1)	1pce	£3
29	Timing Belt	ZZPPHA1-B290 (84946N2)	1pce	£6
31	Tandem Board	(TK7C6300C1)	1pce	£69
35	Paper Out Detection	(TK7C8115C1)	1pce	£33
37	Indicator & Manipulation	(Ver.1,2,3) ZZPPHA1-B370 (TK7C5206C1)	1pce	na
		(Ver.4) ZZPPHA4-B370 (TL7L2303C1)	1pce	£496
40	Guid Shaft	ZZPPHA1-B400 (TK4B3144P1)	1pce	£12
41	Paper Receipt Ass'y	(Ver.1,2) ZZPPHA1-B410 (TK7D6681C1)	1pce	£6
		(Ver.3,4) ZZPPHA3-B420 (TK4D5770P1)	1pce	£6
42	Code Table Name Plate	ZZPPHA1-B420 (TK4B1423P1)	10/pkg	£27
43	FCP Stop Plate	(TK7C6315P1)	10/pkg	£33
44	Specification Name Plate	(TK4A4826P1)	10/pkg	£27
45	Advice Name Plate	(TK4B5620P1)	10/pkg	£27
46	Pully	(TK7C8006P1)	1pce	£3
53	Cable Ass'y	ZZPPHA1-B530 (TK7D7125C1)	1pce	£14
54	Insulation Support	ZZPPHA1-B540 (85313N6)	10/pkg	£14
55	Pan Head Screw With Washer	ZZPPHA1-B550 (813063x6mm)	60/pkg	£1
56	Pan Head Screw With Washer	ZZPPHA1-B560 (813063x16mm)	160/pkg	£3
57	Bearing shaft (Ver.4)	(TK7C8005P1)	1pce	

Name: P. NOUHEN  
Visa:



EDITING

Name: M.NARCHE  
Visa:

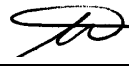

APPROVAL

**COULTON**  
Fuji Electric Instrumentation & Control

INDEX

